



REPÚBLICA DOMINICANA  
JUNTA CENTRAL ELECTORAL

**SOBRE PARA:**

**BOLETAS  
VÁLIDAS**

CANTIDAD DE BOLETAS

\_\_\_\_\_

MUNICIPIO

\_\_\_\_\_

COLEGIO ELECTORAL

①

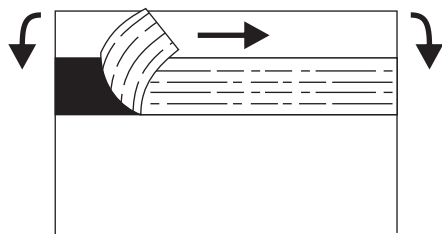

②



③

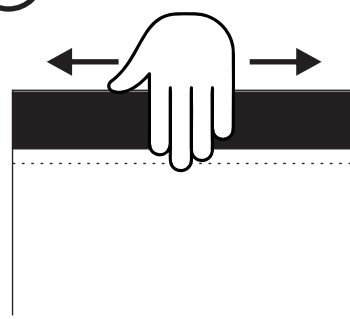



REPÚBLICA DOMINICANA  
JUNTA CENTRAL ELECTORAL

**SOBRE PARA:**

**BOLETAS  
SIN USAR**

CANTIDAD DE BOLETAS

\_\_\_\_\_

MUNICIPIO

\_\_\_\_\_

COLEGIO ELECTORAL

①

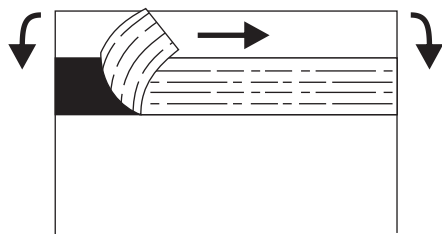

②



③

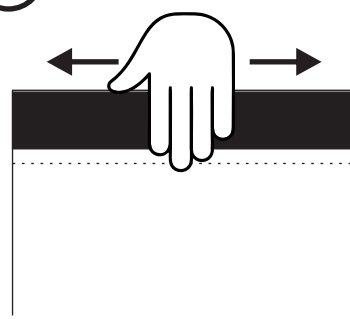



REPÚBLICA DOMINICANA  
JUNTA CENTRAL ELECTORAL

**SOBRE PARA:**

**BOLETAS  
NULAS**

CANTIDAD DE BOLETAS

\_\_\_\_\_

MUNICIPIO

\_\_\_\_\_

COLEGIO ELECTORAL

①

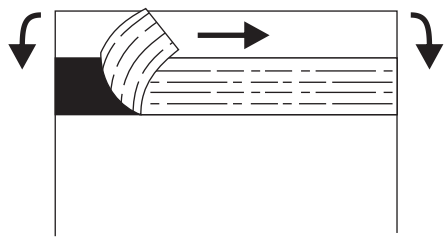

②



③

